

Performance curves

SPK 4

SPK 4

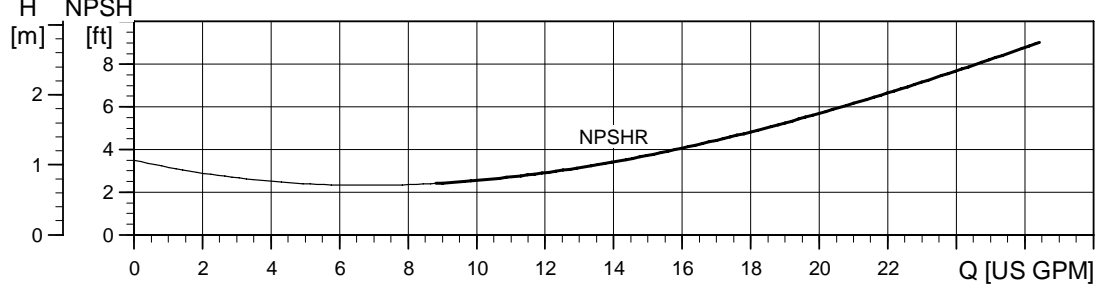
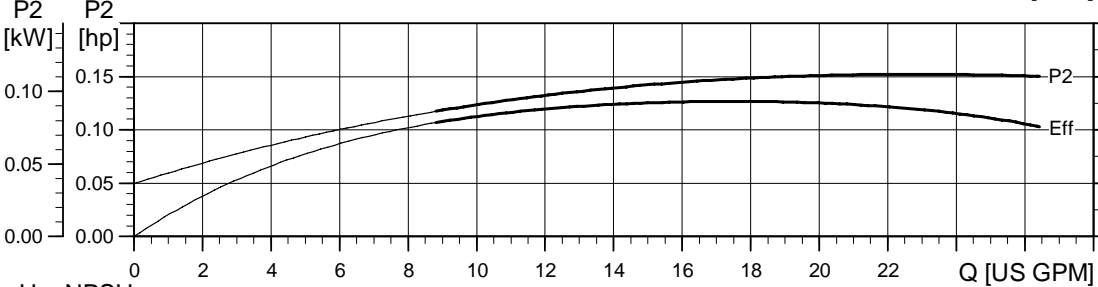
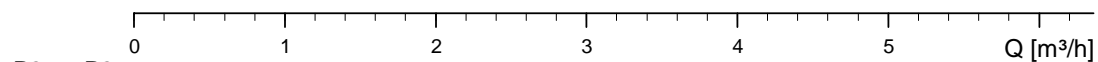
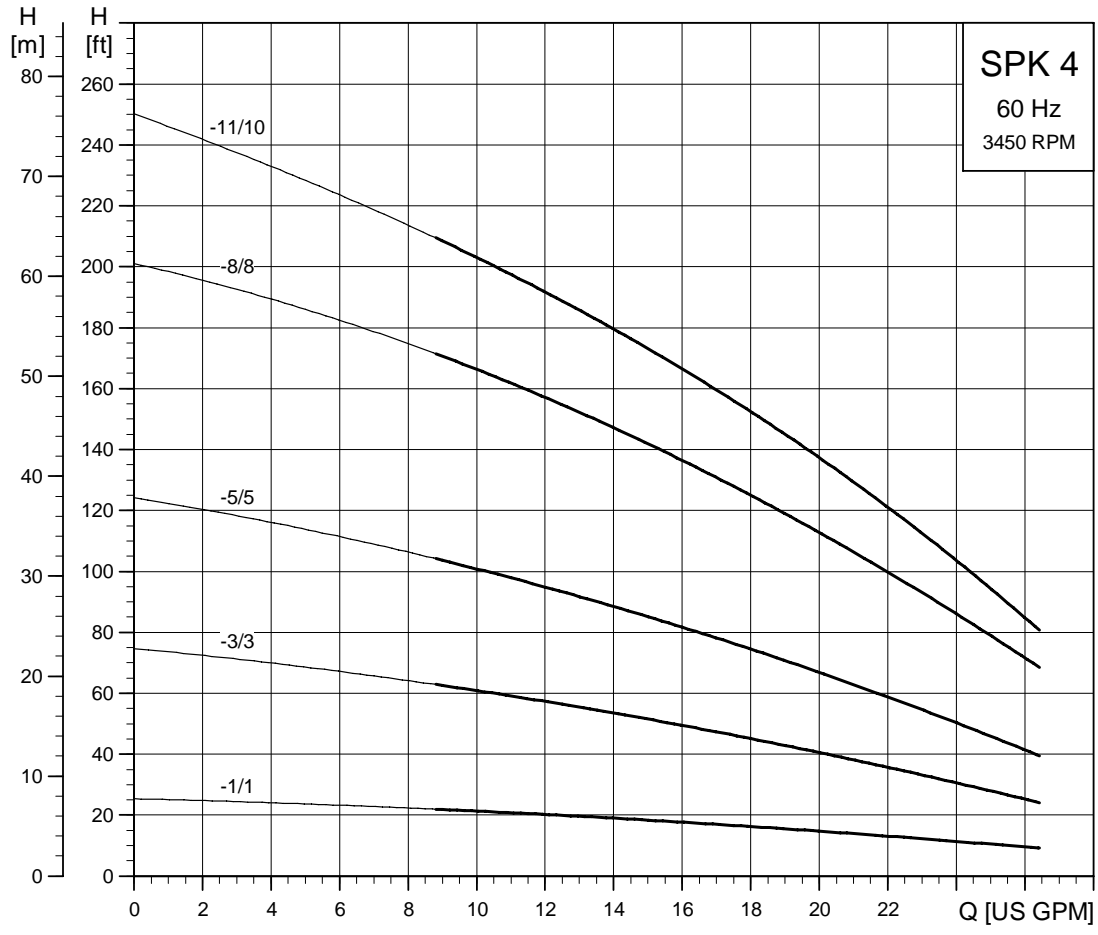

Dimensional sketches

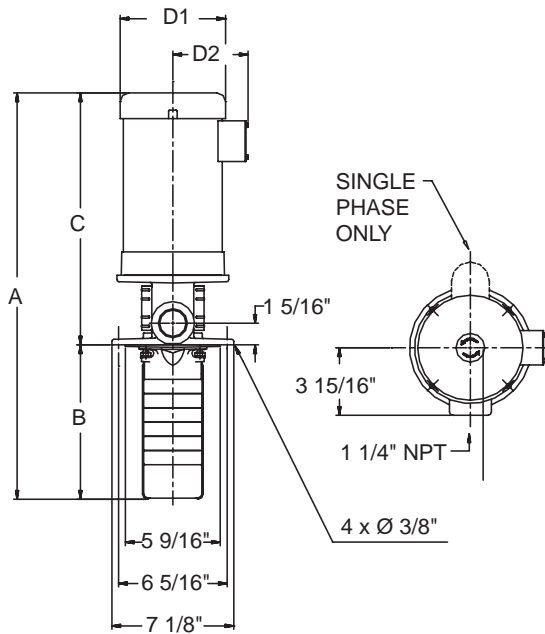

TK00 1918 3297

Dimensions and weights¹

Pump Type	hp	PH	A	B	C	D1	D2	Ship Wt. [lbs.]*
SPK 4-1/1	1/4	1	19	5 5/8	13 3/8	6 1/4	5 1/4	35
		3	17 1/4	5 5/8	11 5/8	5 5/8	4 5/8	33
SPK 4-3/3	1/2	1	20 5/8	7 1/4	13 3/8	6 1/4	5 1/4	37
		3	18 7/8	7 1/4	11 5/8	5 5/8	4 5/8	35
SPK 4-5/5	3/4	1	22 7/8	8 7/8	14	6 1/4	5 1/4	54
		3	20 1/2	8 7/8	11 5/8	5 5/8	4 5/8	40
SPK 4-8/8	1 1/2	1	27 1/8	11 3/8	15 3/4	7 1/4	5 3/4	67
		3	24 1/4	11 3/8	12 7/8	5 5/8	4 5/8	50
SPK 4-11/10	1 1/2	1	29 5/8	13 7/8	15 3/4	7 1/4	5 3/4	69
		3	26 3/4	13 7/8	12 7/8	5 5/8	4 5/8	57
SPK 4-15/10	1 1/2	1	32 7/8	17 1/8	15 3/4	7 1/4	5 3/4	72
		3	30	17 1/8	12 7/8	5 5/8	4 5/8	60
SPK 4-19/10	1 1/2	1	36 1/4	20 1/2	15 3/4	7 1/4	5 3/4	74
		3	33 3/8	20 1/2	12 7/8	5 5/8	4 5/8	62
SPK 4-19/10	1 1/2	1	55 3/8	39 5/8	15 3/4	7 1/4	5 3/4	86
		3	52 1/2	39 5/8	12 7/8	5 5/8	4 5/8	74

* The stated weights apply to SPK only. For SPKI, add 2 lbs.

SPK with extension pipe

Pump Type	hp	PH	A	B	C	D1	D2	Ship Wt. [lbs.]*
SPK 4-19/10	1 1/2	1	55 3/8	39 5/8	15 3/4	7 1/4	5 3/4	85.7
		3	54 3/8	39 5/8	14 3/4	7 1/4	5 3/4	73.8

* The stated weights apply to SPK only. For SPKI, add 2 lbs.

Electrical data¹

HP	PH	NEMA Frame	Service Factor	Voltage	Motor Eff. [%]	Insul. Class	KVA Code	Full Load Current [A]	Service Factor Current [A]	Start Current [A]	Motor Type
1/4	1	56C	1.35	115/230	55	B	K	6.0/3.0	7.6/3.8	28/14	Baldor
	3	56C	1.35	208-230/460	78.5/80	F	L	1.12-1.1/0.55	1.5-1.45/0.75	7.1-10.2/3.9	ML
1/2	1	56C	1.6	115/208-230	62	B	K	7.4/4.1-3.7	9.8/5.2-4.9	39/21.6-19.5	Baldor
	3	56C	1.25	208-230/460	78/79.5	F	K	1.64-1.55/ 0.78	2.0-1.9/0.95	9.7-10.1/5.1	ML
3/4	1	56C	1.25	115/208-230	66	B	K	9.6/5.3-4.8	11.4/6.0-5.7	56/31-28	Baldor
	3	56C	1.25	208-230/460	79/80	F	K	2.4-2.3/1.2	2.9-2.75/1.4	14.2-15/7.8	ML
1	1	56C	1.25	115/230	66	B	K	12/6.0	14.4/7.2	77/38.5	Baldor
	3	56C	1.25	208-230/460	81/81	F	J	3.25-3.35/ 1.68	4.0-3.9/1.95	19.2-21.8/ 10.9	ML

¹ All specifications are for TEFC motors. ODP motors are available on request. For pumps supplied from Grundfos Canada see Notes on page 4.

Flange to strainer length options

Flange to Strainer length options (dimension B)											
Pump Type	No. of Impellers	hp	Inches							All SPK models with extension pipe	
			5 5/8	7 1/4	8 7/8	11 3/8	13 7/8	17 1/8	20 1/2		39 5/8
Stages / Impellers											
SPK 4	1	1/3	-1/1	-3/1	-5/1	-8/1	-11/1	-15/1	-19/1		
SPK 4	3	1/2		-3/3	-5/3	-8/3	-11/3	-15/3	-19/3		
SPK 4	5	3/4			-5/5	-8/5	-11/5	-15/5	-19/5		
SPK 4	8	1 1/2				-8/8	-11/8	-15/8	-19/8		
SPK 4	10	1 1/2					-11/10	-15/10	-19/10		