

# SALES & ENGINEERING DATA

RATIO SERIES: **1:1**

FLUID P.S.I. RANGE: **10 - 100**

## PD03P-XXS-XXX

### 3/8" NON-METALLIC DIAPHRAGM PUMP

RELEASED: 2-17-06  
 REVISED: (REV. 01) S-1386

#### DIMENSIONAL DATA

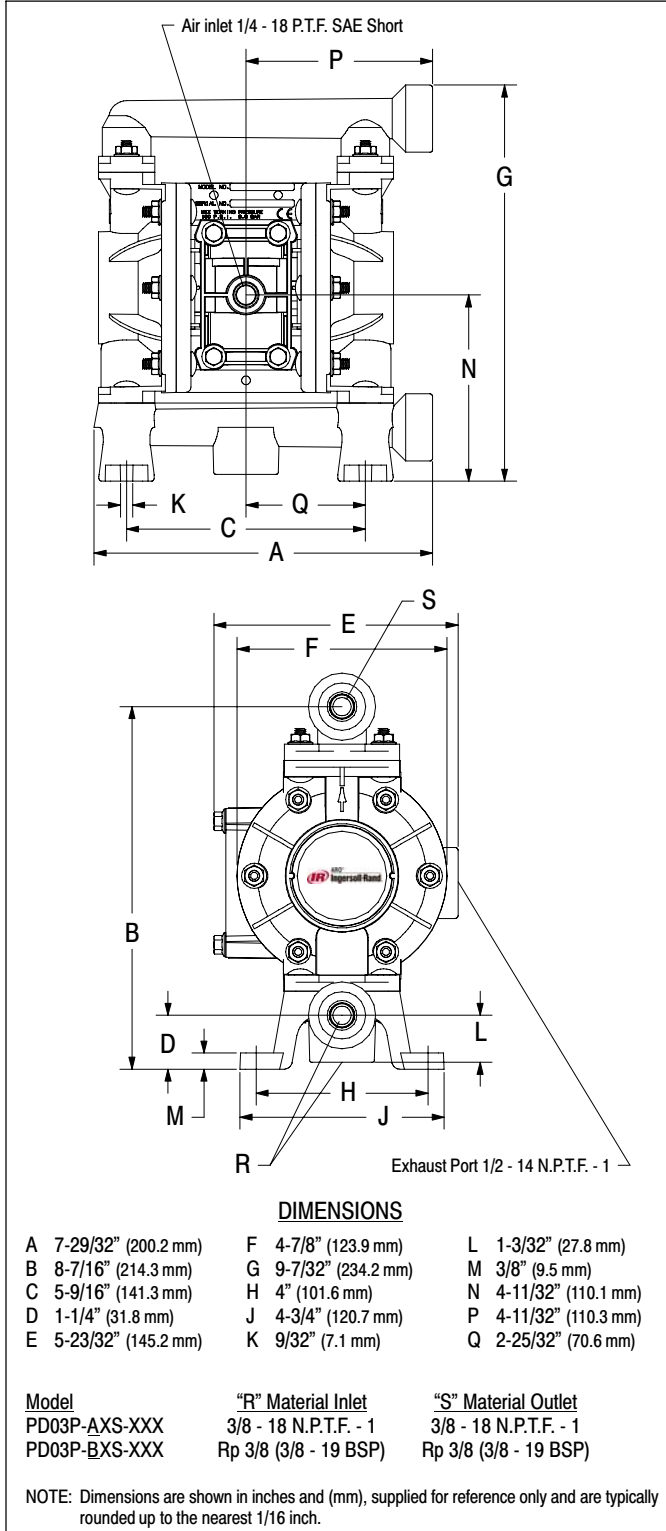

#### SPECIFICATIONS

##### CONSTRUCTION

Model Series	PD03P-XXS-XXX
Pump Type	Non-Metallic, Air Operated, Double Diaphragm
Ratio	1:1
Material Inlet / Outlet (female)	
PD03P-AXS-XXX	3/8 - 18 N.P.T.F. - 1
PD03P-BXS-XXX	Rp 3/8 (3/8 - 19 BSP parallel)
Air Inlet (female)	1/4 - 18 P.T.F. SAE short
Air Exhaust (standard)	internal
(optional) (female)	1/2 - 14 N.P.T.F. - 1
Weight	
PD03P-XDS-XXX	4.16 lbs (1.89 kgs)
PD03P-XES-XXX	4.26 lbs (1.93 kgs)
PD03P-XKS-XXX	4.50 lbs (2.04 kgs)
PD03P-XLS-XXX	4.62 lbs (2.10 kgs)
PD03P-XPS-XXX	3.44 lbs (1.56 kgs)
PD03P-XRS-XXX	3.50 lbs (1.59 kgs)
Air Section Service Kit	637428
Fluid Section Service Kit	637429-XX

PD03P-XXS- X X X  
 637429 - X X X  
 Diaphragm Material  
 Ball Material

EXAMPLE: Model #PD03P-ARS-SAA  
 Fluid Section Service Kit is 637429-AA

##### PERFORMANCE

Air Inlet Pressure Range	10 - 100 p.s.i. (0.69 - 6.9 bar)
Maximum Material Inlet Pressure	10 p.s.i. (0.69 bar)
Fluid Outlet Pressure Range	10 - 100 p.s.i. (0.69 - 6.9 bar)
Maximum Flow Rate (flooded inlet)	10.6 g.p.m. (40.1 l.p.m.)
Displacement / Cycle @ 100 p.s.i.	0.022 gal. (0.083 lit.)
Maximum Particle Size	1/16" dia. (1.6 mm)
Maximum Temperature Limits (diaphragm / ball / seat material)	
Acetal	10° to 180° F (-12° to 82° C)
Hytre	-20° to 150° F (-29° to 66° C)
Polypropylene	35° to 150° F (2° to 66° C)
PVDF (Kynar)	10° to 200° F (-12° to 93° C)
Santoprene	-40° to 225° F (-40° to 107° C)
P.T.F.E. (Teflon)	40° to 225° F (4° to 107° C)
Viton	-40° to 350° F (-40° to 177° C)
Noise Level @ 70 p.s.i. - 60 c.p.m.	72.7 db(A) <sup>①</sup>

##### Notes:

① The pump sound pressure level has been updated to an Equivalent Continuous Sound Level (L<sub>Aeq</sub>) to meet the intent of ANSI S1. 13-1971, CAGI-PNEUROPS S5.1 using four microphone locations.

##### ACCESSORIES:

- 66073-1 Air Line Connection Kit
- 67388 Wall Mount Bracket Assembly
- 93110 Muffler
- 637438 Ported Exhaust Kit



PERFORMANCE CURVES

PD03P-XXS-XXX 3/8" NON-METALLIC DIAPHRAGM PUMP

