

Performance curves

SPK 8

SPK 8

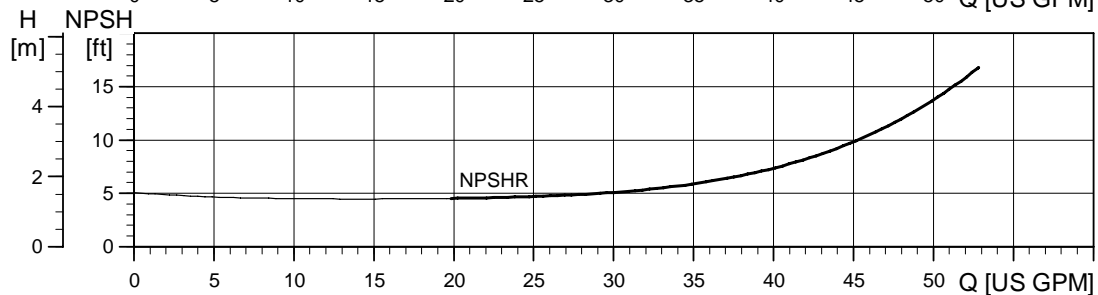
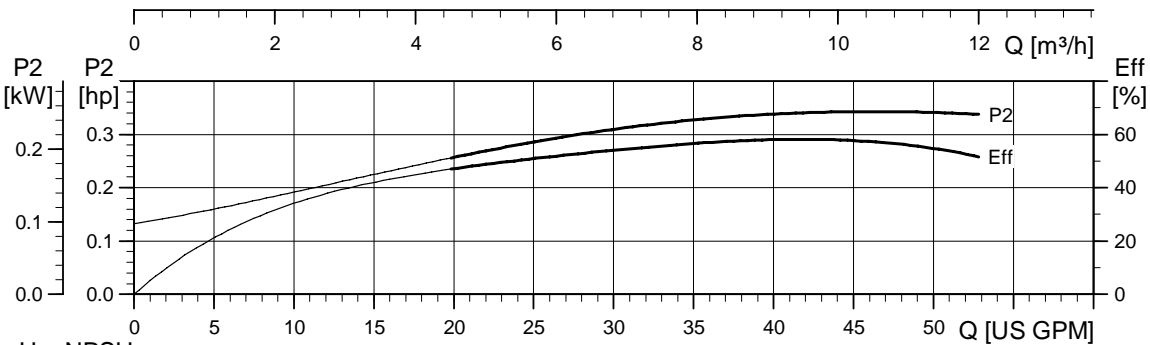
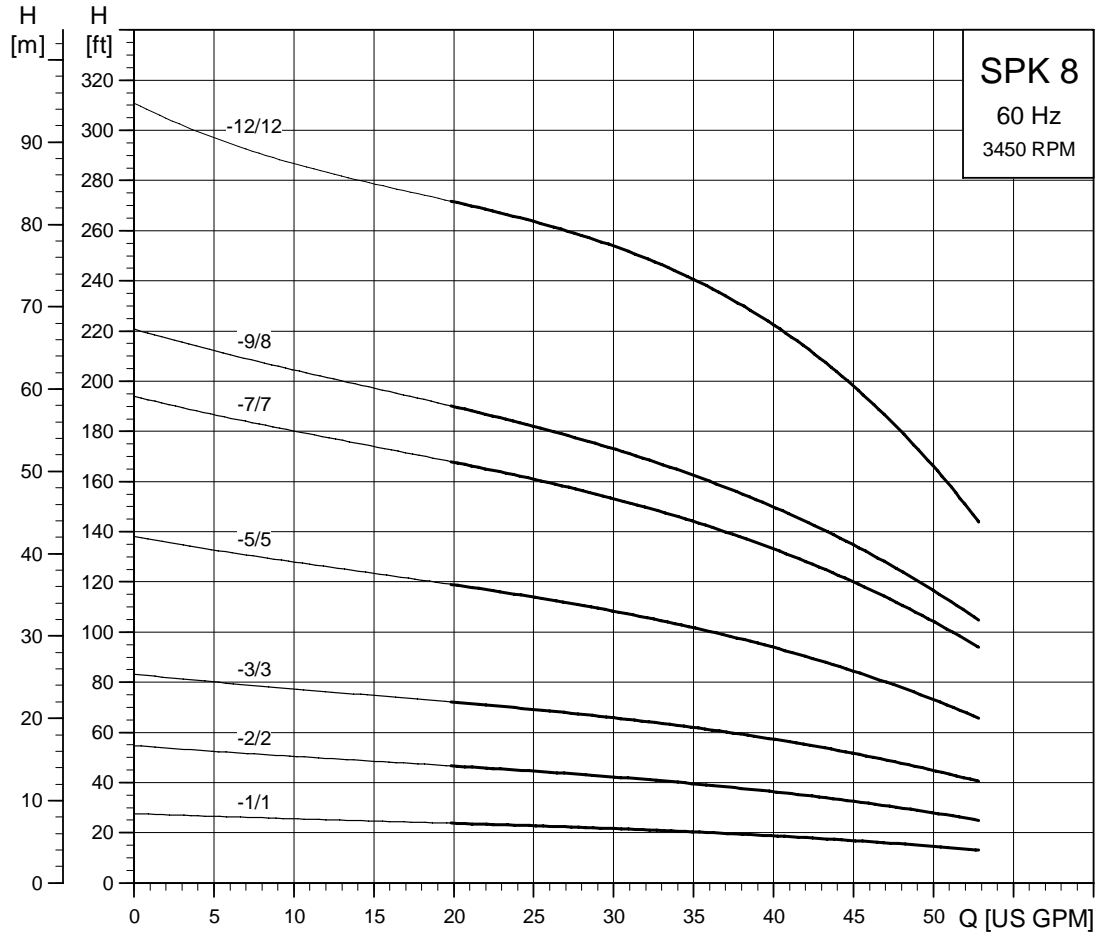

Dimensional sketches

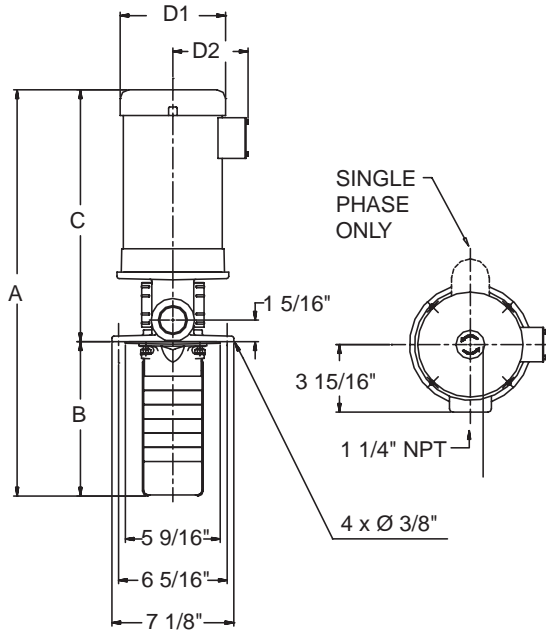

Dimensions and weights¹

Pump Type	hp	PH	A	B	C	D1	D2	Ship Wt. [lbs.]*
SPK 8-1/1	1/2	1	20 5/8	7 1/4	13 3/8	6 1/4	5 1/4	42
		3	18 7/8	7 1/4	11 5/8	5 5/8	4 5/8	40
SPK 8-2/2	3/4	1	22 7/8	8 7/8	14	6 1/4	5 1/4	59
		3	20 1/2	8 7/8	11 5/8	5 5/8	4 5/8	50
SPK 8-3/3	1 1/2	1	26 1/4	10 1/2	15 3/4	7 1/4	5 3/4	71
		3	23 3/8	10 1/2	12 7/8	5 5/8	4 5/8	47
SPK 8-5/5	2	1	30 1/2	13 7/8	16 5/8	7 1/4	5 3/4	73
		3	29 3/8	13 7/8	15 1/2	7 1/8	4 3/8	63
SPK 8-7/7	3	1	35 7/8	17 1/8	18 3/4	8 5/8	6 7/8	87
		3	33 1/8	17 1/8	16	7 1/8	4 3/8	80
SPK 8-9/8	3	1	39 1/4	20 1/2	18 3/4	8 5/8	6 7/8	89
		3	36 1/2	20 1/2	16	7 1/8	4 3/8	78
SPK 8-12/12	5	1	45	25 3/8	19 5/8	10 5/8	7 1/2	162
		3	43	25 3/8	17 5/8	7 1/8	4 3/8	120
SPK 8-15/12	5	1	50	30 3/8	19 5/8	10 5/8	7 1/2	165
		3	48	30 3/8	17 5/8	7 1/8	4 3/8	123
SPK 8-15/12	5	1	59 1/4	39 5/8	19 5/8	10 5/8	7 1/2	171
		3	57 1/4	39 5/8	17 5/8	7 1/8	4 3/8	129

* The stated weights apply to SPK only. For SPKI, add 2 lbs.

SPK with extension pipe

Pump Type	hp	PH	A	B	C	D1	D2	Ship Wt. [lbs.]*
SPK 8-15/12	5	1	59 1/4	39 5/8	19 5/8	10 5/8	7 1/2	171.2
		3	59 7/8	39 5/8	20 1/4	8 1/2	6	129.3

* The stated weights apply to SPK only. For SPKI, add 2 lbs.

Electrical data¹

HP	PH	NEMA Frame	Service Factor	Voltage	Motor Eff. [%]	Insul. Class	KVA Code	Full Load Current [A]	Service Factor Current [A]	Start Current [A]	Motor Type
1/2	1	56C	1.6	115/208-230	62	B	K	7.4/4.1-3.7	9.8/5.2-4.9	39/21.6-19.5	Baldor
	3	56C	1.25	208-230/460	78/79.5	F	K	1.64-1.55/ 0.78	2.0-1.9/0.95	9.7-10.1/5.1	ML
3/4	1	56C	1.25	115/208-230	66	B	K	9.6/5.3-4.8	11.4/6.0-5.7	56/31-28	Baldor
	3	56C	1.25	208-230/460	79/80	F	K	2.4-2.3/1.2	2.9-2.75/1.4	14.2-15/7.8	ML
1 1/2	1	56C	1.3	115/208-230	71	B	K	17/9.5-8.6	20.4/11.3-10.2	106/58.6-53	Baldor
	3	56C	1.15	208-230/460	83/84	F	M	4.7-4.6/2.3	5.2-5.1/2.55	33.8-36.8/ 18.4	ML
2	1	56C	1.15	115/208-230	74	F	K	23/12.7-11.5	25.4/14.1-12.7	156/86.2-78	Baldor
	3	56C	1.15	208-230/460	84.5/ 85.5	F	G	5.7-5.4/2.7	6.55-6.1/3.05	46.2-48.6/ 24.3	ML
3	1	182TC	1.15	115/208-230	75	F	H	29/16-14.5	31.8/18-15.9	170/94-85	Baldor
	3	182TC	1.15	208-230/460	82.5/84	F	K	8.9-8.5/4.25	10.4-9.5/4.75	60.5-63.8/ 31.9	ML
5	1	213TC	1.15	208-230	80	F	J	24-22	27-25	188-170	Baldor
	3	184TC	1.15	208-230/460	84.5/86	F	S	14.2-14/7.0	16-15.4/7.7	109-119/59.5	ML

¹ All specifications are for TEFC motors. ODP motors are available on request. For pumps supplied from Grundfos Canada see Notes on page 4.

Flange to strainer length options

Pump Type	No. of Impellers	HP	Flange to Strainer length options (dimension B)								
			Inches								
			7 1/4	8 7/8	10 1/2	13 7/8	17 1/8	20 1/2	25 3/8	30 3/8	39 5/8
Stages / Impellers											
SPK 8	1	1/2	-1/1	-2/1	-3/1	-5/1	-7/1	-9/1	-12/1	-15/1	All SPK models with extension pipe
SPK 8	2	3/4		-2/2	-3/2	-5/2	-7/2	-9/2	-12/2	-15/2	
SPK 8	3	1 1/2			-3/3	-5/3	-7/3	-9/3	-12/3	-15/3	
SPK 8	5	2				-5/5	-7/5	-9/5	-12/5	-15/5	
SPK 8	7	3					-7/7	-9/7	-12/7	-15/7	
SPK 8	8	3						-9/8	-12/8	-15/8	
SPK 8	12	5							-12/12	-15/12	